



Project Name/No: \_\_\_\_\_ Item No: \_\_\_\_\_

Quantity: \_\_\_\_\_ SIS#: \_\_\_\_\_ AIA/CSI#: \_\_\_\_\_

# Free-Standing Ventless Recirculating Hood

## Model FSH-2



- Free-standing design allows you to add deep fryers to the cook line without need for expensive building modifications or costly expansion of an existing conventional ventilation system.
- Venting to the outside is not necessary. Generally, the FSH-2 can be used where traditional hood solutions are prohibited or do not fit within your budget.
- Models are available for 1 or 3-phase power. The 3-ph model features a built-in, interlocked, appliance power receptacle in the hood base ... **50A** (max).
- UL listed for use with approved cooking appliances (**fryers only**) and features Giles' proven 3-stage air cleaning system for capturing & removing grease-laden cooking vapors from the air. Listed to **UL-YZCT** (Canadian **UL-YZCT-7**) ... **complies with ANSI/UL-710B**.
- Accommodates floor-model fryers from 10" to 24" wide ... specify centering bracket size.
- Low-profile exhaust air diverter minimizes required ceiling height clearance.
- Hood features factory-installed, self-contained **Ansul® R102 Wet Chemical Fire Suppression System**, consisting of *Automan* release mechanism, 1-1/2 gallon tank, piping, discharge nozzles, detector link brackets and cable conduit. **Customer shall provide for final field installation, set-up, charging & commissioning ... work must be performed by an authorized Ansul® Distributor/Dealer ... not included with purchase.**

### Design Features

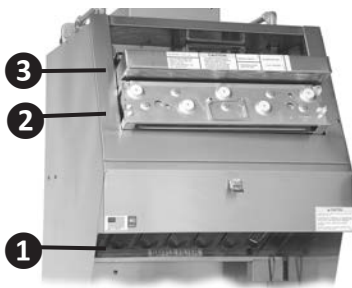

#### Ventless Hood 3-Stage Air Cleaning:

- Stage 1** - Stainless steel baffle filter traps largest grease particulate.
- Stage 2** - Sustainable Electronic Air Cleaner (E.A.C.) cell electrostatically captures & collects finer grease particulate on plates in the cell.
- Stage 3** - Disposable charcoal filter helps control cooking odors in exhaust air.

#### Standard Features:

- Complete filter set.
- Built-in fire suppression system.
- Built-in appliance power receptacle (3-ph model).
- **PUSH-TO-START** power switch ... hood must be manually restarted after power interruptions in order to power the cooking appliance underneath.
- Adjustable leveling legs.
- Low-profile exhaust air diverter ... reduces required ceiling clearance.
- Built-in filter cleaning timer ... helps maintain optimum hood performance.

#### !! IMPORTANT INFORMATION !!

Orders for *GILES Recirculating/Ventless Hood* systems will not be accepted until Giles confirms ... 1) Purchaser has received all necessary approvals from local authorities ... 2) the appliance to be used is within the hood's listing limitations ... 3) the Purchaser is aware of specific site requirements & limitations stated in the *GFSE Recirculating/Ventless Hood Approval Letter (HAL)* which must be complied with during installation. The HAL must be completed, submitted (along with any requested documentation) and approved by Giles before an order is accepted and production is initiated.

The HAL document is available for download at [www.gfse.com](http://www.gfse.com) under the *SUPPORT* tab in *VENTLESS DOCUMENTS*.

### Appliance Limitations: **IMPORTANT! HOOD LISTED ONLY FOR USE WITH ELECTRICALLY HEATED FRYERS ... NO GAS**

Listed for **FRYERS only** ... must conform to the following limitations:

- Maximum cooking power: **20 kW**
- Maximum cooking surface area: **380 sq in [2,452 sq cm]**
- Maximum cooking temp (fryers): **350°F [177°C]**
- Maximum shortening capacity: **110 lbs [50 kg]**
- Fryer width (side to side): **10" [254 mm] to 24" [610 mm]**

**GILES Food Service Equipment** ▪ ISO 9001-2015 Registered

PO Box 210247; 2750 Gunter Park Drive W; Montgomery, AL 36109 USA

334.272.1457 ▪ Fax 334.239.4117 ▪ Toll Free 800.554.4537 (US/Canada Only) ▪ [www.gfse.com](http://www.gfse.com) ▪ Email: [services@gfse.com](mailto:services@gfse.com)

# Ventless Hood Model FSH-2

Project Name/No: \_\_\_\_\_ Item No: \_\_\_\_\_

Quantity: \_\_\_\_\_ SIS#: \_\_\_\_\_ AIA/CSI#: \_\_\_\_\_

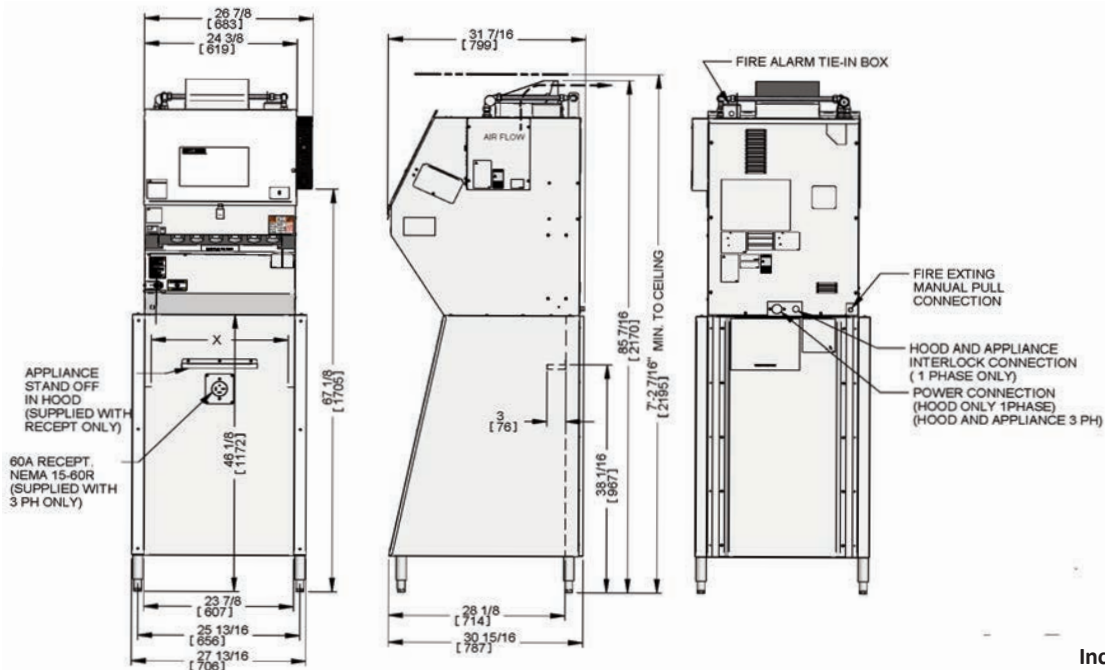

Inches [mm]

## Specifications

**Construction:** 16, 18 & 20-ga. stainless steel & aluminized steel where applicable

Dimensions:		
Width	Depth	Height
27-13/16" [706 mm]	30-15/16" [786 mm]	85-7/16" [2170 mm]

Electrical Specifications: (Hood Only)		
Voltage	Phase	Amps
208-240	1 or 3	5

• Power cord NOT provided; field wiring required.

### Ventless Hood:

- Exhaust: 510 - 680 CFM
- Approx. Sound Level: 65 dB

### Shipping Specifications:

Width	Length	Height	Cube	Crated Weight
46" [1168 mm]	35" [1067 mm]	96" [2438 mm]	89.4 cu ft [2.53 cu m]	425 lbs [193 kg]

**Accessory Items Included:** Baffle Filter • EAC Collector Cell • Charcoal Filter • (1) Can, Spray Foam EAC Cell Cleaner (sample)

## IMPORTANT! Before Ordering

- Purchaser must obtain, complete and submit the Hood Approval Letter (HAL) to Giles for approval. By signing the HAL, purchaser affirms that the intended installation site has been assessed and is compliant with the minimum requirements, stated therein ... kitchen size, ceiling height, fresh outside air supply, room air exchange rate, exhaust ventilation, clearances, etc.
- Verify that fryer to be used is within limits shown on first page ... contact factory to resolve any questions.
- Does available electrical power meet the hood specifications?

## How To Specify

### 1 Specify Appliance Opening [X]:

Oversize 1/8" to 1/4" [3.2 mm - 6.4 mm] for sufficient clearance.

✓	Opening Designation	Width [X]	✓	Opening Designation	Width [X]
	A	24-1/8 [613]		E	15-5/8 [397]
	B	20-1/8 [511]		F	15-1/8 [384]
	C	18-5/8 [473]		G	14-1/8 [359]
	D	16-1/8 [410]		H	10-1/8 [257]

### 2 Specify Electrical:

Choose from the following:

✓	Voltage	Hz	Ph
	208-240	60	1
	208-240	60	3

**3-ph unit includes built-in NEMA 15-60R appliance power receptacle ... 50A max.**

### 3 Extra Accessories (sold separately):

✓	Qty	Description	Part No.
		Baffle Filter	42300
		E.A.C. Collector Cell	20520
		Charcoal Filter	30248
		Foaming Spray EAC Cleaner (12-ct Case, 20-oz Cans)	41510

### 4 Shipping - Specify shipping method