



Responsive. Reliable.

Project Name/No: _____ Item No: _____

Quantity: _____ SIS#: _____ AIA/CSI#: _____

Free-Standing Ventless Recirculating Hood

Model FSH-2



- The free-standing design allows you to add deep fryers in the cook line without the need for expensive kitchen modifications or the hassles of installing, or expanding an existing conventional ventilation hood.
- No venting to outside necessary. Generally, can be used where traditional hood solutions are prohibited or too costly.
- Models for 1-phase or 3-phase power available. 3-ph model features a built-in, interlocked, 50A max, appliance power receptacle in the hood base.
- UL listed for use with approved appliances (**fryers only**) and features Giles' proven 3-stage air cleaning system, for capturing and removing grease-laden cooking vapors. Listed to **UL-YZCT (-7 Canada) and complies with ANSI/UL-710B**.
- Accommodates fryers from 10" to 24" wide; specified brackets center appliance position under hood.
- Low-profile exhaust air diverter minimizes required ceiling height clearance.
- Hood features factory-installed, self-contained, **Ansul® R102 Wet Chemical Fire Suppression System**, consisting of *Automan* release mechanism, 1-1/2 gallon tank, piping, appliance/plenum nozzles, detector link brackets and cable conduit. **Customer shall provide for final field installation, set-up, charging and commissioning ... must be performed by an authorized Ansul® Distributor/Dealer. Not included with hood purchase.**

Design Features

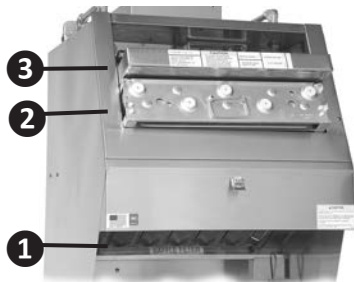

Ventless Hood 3-Stage Air Cleaning:

- Stage 1** - Stainless steel baffle filter traps largest grease particulate.
- Stage 2** - Sustainable Electronic Air Cleaner (E.A.C.) captures & collects fine grease particulate on fins in the cell with electrostatic action.
- Stage 3** - Disposable charcoal filter helps control cooking odor in the exhausted air.

Standard Features:

- Complete filter set.
- Built-in fire suppression system.
- Built-in appliance power receptacle on 3-ph models.
- **PUSH-TO-START** power switch ... hood must be manually restarted after power interruptions, to provide power to appliance underneath.
- Adjustable leveling legs.
- Low-profile exhaust air diverter ... reduces required ceiling clearance.
- Built-in filter cleaning reminder feature ... helps user maintain optimum hood performance.

!! IMPORTANT INFORMATION !!

Orders for GILES Recirculating/Ventless Hood systems will not be accepted until Giles confirms, 1). that the Purchaser has received all necessary approvals from local authorities, 2). that the appliances to be used are within the hood's listing limitations, and 3). that the Purchaser is aware of specific site requirements & limitations, which must be complied with during installation, as stated in the GFSE Recirculating/Ventless Hood Approval Letter. The Hood Approval Letter (HAL) must be completed and submitted (along with any requested documentation), and then approved by Giles before the order is accepted and production is initiated.

The HAL document is available for download at www.gfse.com under the SUPPORT tab in VENTLESS DOCUMENTS.

Appliance Limitations: IMPORTANT! HOOD LISTED ONLY FOR USE WITH ELECTRICALLY HEATED FRYERS ... NO GAS

Listed for **FRYERS** only, which must conform to the following limitations:

- Maximum power: **20 kW**
- Maximum cooking surface area: **380 sq in [2,452 sq cm]**
- Maximum cooking temp (fryers): **350°F [177°C]**
- Maximum shortening capacity: **110 lbs [50 kg]**
- Fryer width (side to side): **10" [254 mm] to 24" [610 mm]**

GILES Food Service Equipment ▪ ISO 9001-2015 Registered

PO Box 210247; 2750 Gunter Park Drive W; Montgomery, AL 36109 USA

334.272.1457 ▪ Fax 334.239.4117 ▪ Toll Free 800.554.4537 (US/Canada Only) ▪ www.gfse.com ▪ Email: services@gfse.com

Ventless Hood Model FSH-2

Project Name/No: _____ Item No: _____

Quantity: _____ SIS#: _____ AIA/CSI#: _____

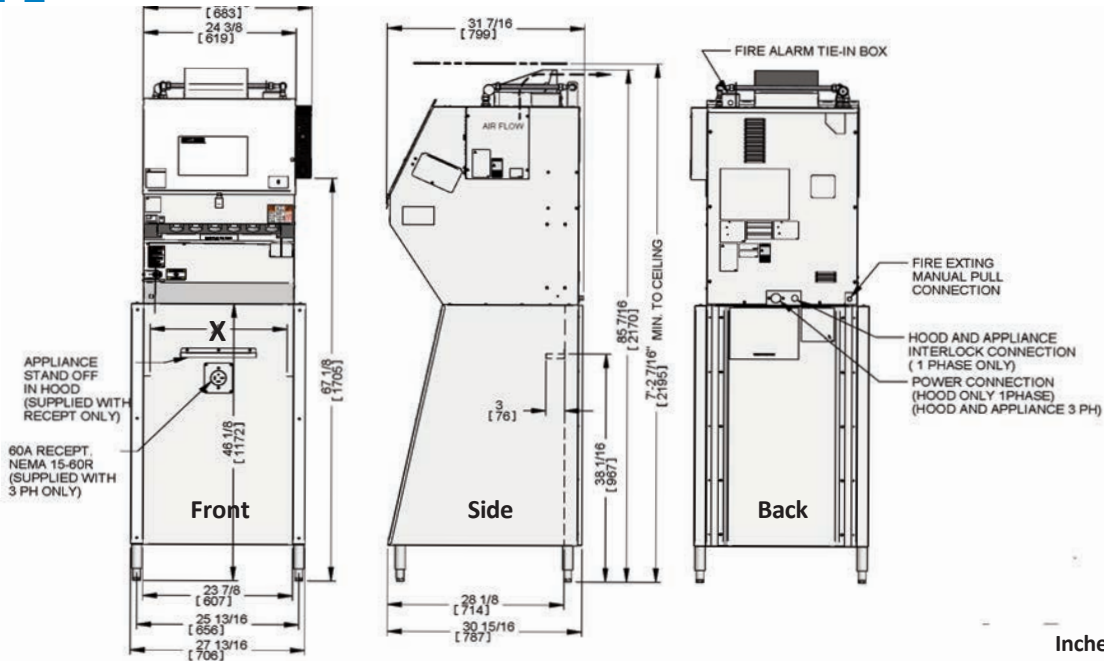

Inches [mm]

Specifications

Construction: 16, 18 & 20-ga. stainless steel ... aluminized steel as applicable

Dimensions:		
Width	Depth	Height
27-13/16" [706 mm]	30-15/16" [786 mm]	85-7/16" [2170 mm]

Ventless Hood:

- Exhaust: 510 - 680 CFM
- Approx. Sound Level: 65 dB

Electrical Specifications: (Hood Only)		
Voltage	Phase	Amps
208-240	1 or 3	5

▪ **Power cord NOT provided; field wiring required.**

Shipping Specifications:

Width	Length	Height	Cube	Crated Weight
46" [1168 mm]	35" [1067 mm]	96" [2438 mm]	89.4 cu ft [2.53 cu m]	425 lbs [193 kg]

Accessory Items Included: Baffle Filter • EAC Collector Cell • Charcoal Filter • (1) Can, Spray Foam EAC Cell Cleaner (sample)

IMPORTANT! Before Ordering

- **Purchaser must obtain, read, complete, and submit the Giles Hood Approval Letter (HAL) for approval. By signing the HAL, Purchaser affirms that the intended installation site has been assessed and is compliant with the minimum requirements, stated therein ... kitchen size, ceiling height, fresh outside air supply, room air exchange rate, exhaust ventilation, clearances, etc.**
- Verify that fryer to be used is within limits shown on first page ... contact factory to resolve any questions.
- Does available electrical power meet hood specifications?

How To Specify

1 Specify Appliance Opening [X]:

Upsize 1/8" to 1/4" [3.2 mm - 6.4 mm] for sufficient clearance.

✓	Opening Designation	Width [X]	✓	Opening Designation	Width [X]
	A	24-1/8 [613]		E	15-5/8 [397]
	B	20-1/8 [511]		F	15-1/8 [384]
	C	18-5/8 [473]		G	14-1/8 [359]
	D	16-1/8 [410]		H	10-1/8 [257]

2 Specify Electrical:

Choose from the following:

✓	Voltage	Hz	Ph
	208-240	60	1
	208-240	60	3

3-ph unit includes built-in NEMA 15-60R appliance power receptacle ... 50A max.

3 Extra Accessories (sold separately):

✓	Qty	Description	Part No.
		Baffle Filter	42300
		E.A.C. Collector Cell	20520
		Charcoal Filter	30248
		Foaming Spray EAC Cleaner (12-ct Case, 20-oz Cans)	41510

4 Shipping - Specify shipping method



2750 Gunter Park Drive West • Montgomery, AL 36109 USA
334.272.1457 • Toll Free: 800.554.4537

Giles reserves the right to change specifications and/or product design without notice. Such revisions do not entitle the buyer to corresponding changes, improvements, additions or replacement with respect to previously purchased equipment.

Printed in USA, Form 60656 (Rel. Date: Feb.2000; Rev. Date: Aug.2020, Rev. I)