

DEPT.: -----		RAW MAT'L: -----			
REVISIONS					
SYM.	DESCRIPTION	DATE	BY	ECO #	
A	FOR REFERENCE ONLY	11/98	EED	98135	
B	ROUNDED MILLIMETERS	6/00	CSY	-----	

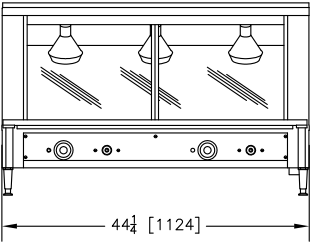

GHM4 - 3 WELL

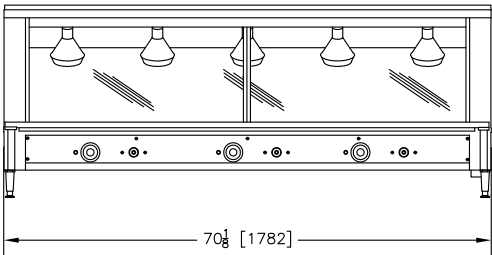

GHM6 - 5 WELL

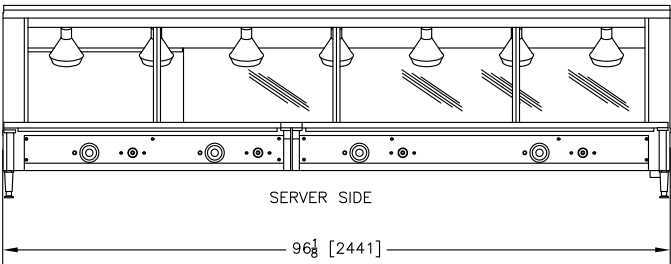

GHM8/2L - 7 WELL

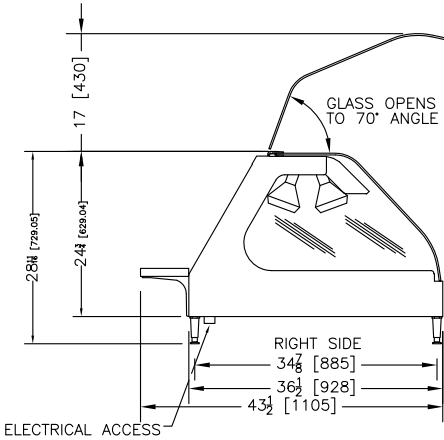

ITEM	P/N	SIZE	QTY.	DESCRIPTION
BILL OF MATERIALS				
Giles Enterprises, Inc.				MOBILE, ALABAMA
RESTRICTED CONFIDENTIAL DOCUMENT				
THIS DRAWING AND ALL THE INFORMATION HEREON ARE THE EXCLUSIVE PROPERTY OF GILES ENTERPRISES, INC. AND THE INFORMATION HEREON ARE NOT TO BE REPRODUCED OR TRANSMITTED IN ANY FORM OR BY ANY MEANS, ELECTRONIC OR MECHANICAL, INCLUDING PHOTOCOPYING, RECORDING, OR BY ANY INFORMATION STORAGE AND RETRIEVAL SYSTEM, WITHOUT THE WRITTEN PERMISSION OF GILES ENTERPRISES, INC. THE USER OF THIS DRAWING SHALL BE MADE TO A WRITTEN STATEMENT OF THE USER'S INTENT TO REPRODUCE OR TRANSMIT THIS DRAWING.				
CONTROL OF GILES DRAWINGS				
TITLE:		3-VIEW DRAWING		
DECIMALS .XXX = 0.031 .XXX = 0.010		GHM4,6,8		
ANGULAR ± 2°		MACHINE SHOP		
TOLERANCES UNLESS OTHERWISE SPECIFIED		SCALE NONE		
FRACTIONS 1/16, 1/8, 1/4, 3/8, 1/2, 5/8, 3/4, 7/8		SIZE: 11/16, 7/8		DWG. NO. 36196
OTHERWISE SPECIFIED		CUT BY: BTD		REV. B